

# Nr. 10001 Gipsabscheider / Plaster separator

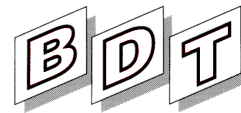

BDT GmbH  
Industriestr. 27  
77656 Offenburg

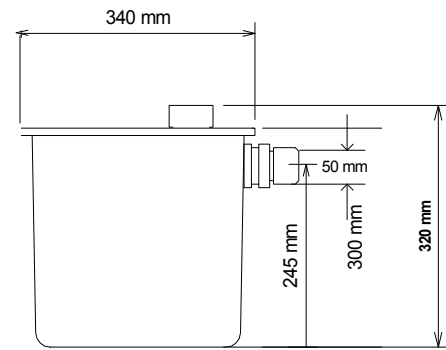
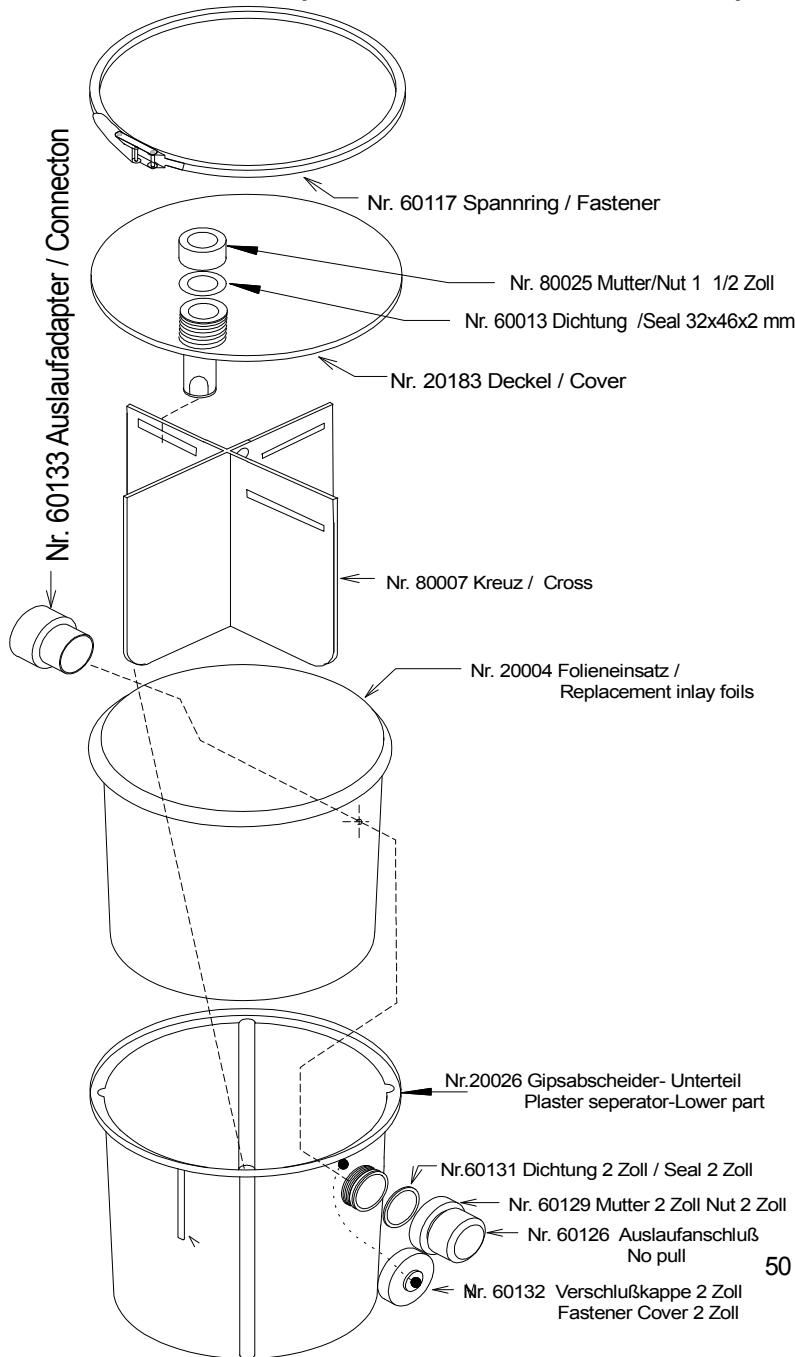

**Hinweis:**  
Der Ablauf des Gipsabscheiders muss höher liegen als der Wandeinlauf

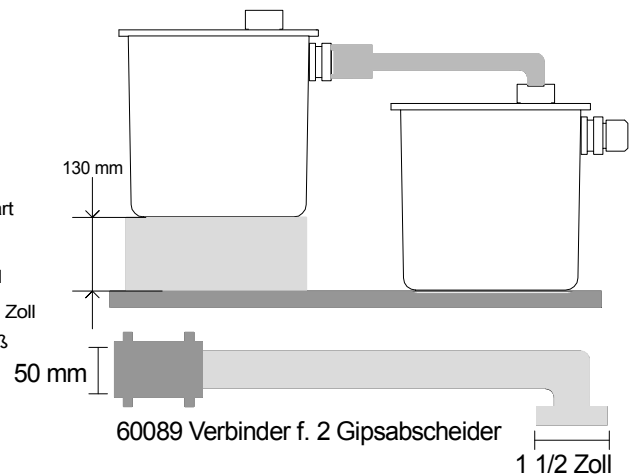

## Zubehör:



70073  
Zulauf-  
schlauch-  
gerade

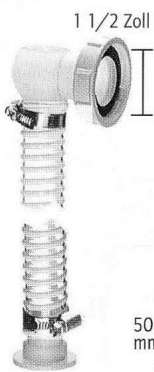

70074  
Zulauf-  
schlauch  
90°

